

CAV SPEAKER SYSTEM

广东汉洋电器有限公司
CAV INC.

品名：Hi-Fi扬声器系统 型号：MD-VI
生产：广州汉林电器实业有限公司
地址：广州市番禺区化龙镇石化公路明经路段9号

Model:MD-VI Speaker System
Manufacturer: Cav Audio (Guangzhou) Co.,Ltd
Address: 9, MingJing Industrial District Hualong, Panyu,Guangzhou,China

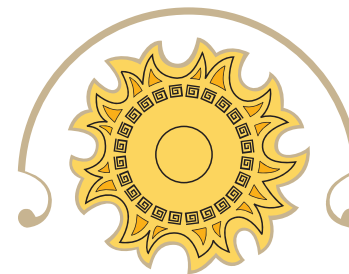

MD-VI

扬声器系统使用说明书

SPEAKER SYSTEM OPERATING INSTRUCTIONS

MD-VI

扬声器系统使用说明书

尊敬的用户：

感谢您购买了MD-VI，它是CAV倾力制作的一款具有精湛技术和深厚艺术内涵完美结合的扬声器系统，该系统是CAV表现美学、艺术形式与真实音乐合而为一的理想载体，也是本公司独具个性的又一代表性产品。

本公司的企业精神是高尚生活，愿您体验高尚生活中的音乐。

为获得最佳性能和完备的服务支持，敬请仔细阅读本说明书，并妥善保存以备将来查阅。

MD-VI

扬声器系统使用说明书

主要特点：

- 1、箱体采用多层复合板材冷轧技术及三维宫格支撑技术
箱体板材采用多层高密度纤维板冷轧粘合，在提高板材的强度和韧性的同时内阻尼同时得到增大，有效的消除箱振；三维宫格支撑技术即箱体内部纵横多层木架支撑，箱体大动态的播放时的共振得到有效抑制，消除箱体自身振动产生的音染。
- 2、高音采用Scan-Speak（丹麦绅士宝）Beryllium tweeter铍高音
Scan-Speak（丹麦绅士宝）Beryllium 铍振膜技术使声速在振膜中的传输速度达11000m/s,比普通材料高很多，系统声音极为清晰透彻，相位失真降到最低。
- 3、中音、低音采用德国伊顿ETON的HEXACONE六角蜂巢振膜喇叭
德国伊顿ETON的中音、低音喇叭采用了HEXACON三明治六角蜂巢振膜技术，在提高刚性的同时还能增大振盆内部阻尼，使中频声音更清晰、更干净，同时振动质量的降低可以显著的改善低频的瞬态响应，速度更快，失真更低。
- 4、喇叭系统设计LEAP曲线优化
喇叭系统设计过程反复用LEAP系统曲线优化，每个部件的参数值都达到最佳状态。

注意事项：

- 1、音箱连接线应确实与功率放大器连接可靠，否则会产生噪声。
- 2、音箱应放置于水平、坚固的地方。音箱后背离墙应有大约20-50厘米距离，会使低音更为丰满。
- 3、如果音箱的极性接反，会导致立体声效果不佳。

保养：

- 1、如无必要，请尽量避免音箱在满负荷的状态下长时间工作。
- 2、开机前，请注意功率放大器音量旋钮的位置，应在最小或较小音量位置才开机。
- 3、清洁音箱表面，请用干软布擦净。切记不要用天拿水、汽油等化学溶剂，否则会损坏音箱表面。

附件：

音箱连接线3.6米2条。

注：上述规格如有变动，恕不另行通知。

MD-VI

CURVE FOR FREQUENCY AND IMPEDANCE

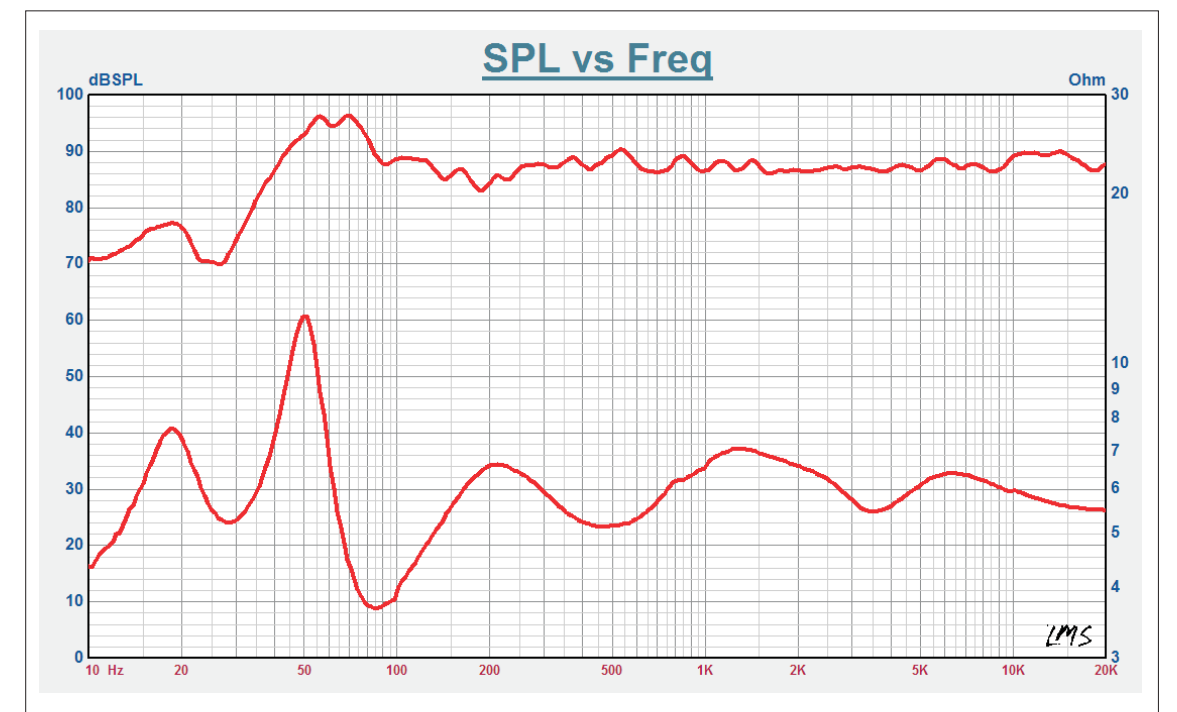

MD-VI SPL/IMP

A diagram of a three-way speaker system. On the left, three labels are listed vertically: "Tweeter", "Midrange", and "Woofer". Each label has a horizontal arrow pointing to the right. The "Tweeter" arrow points to the top driver of the speaker. The "Midrange" arrow points to the middle driver. The "Woofer" arrow points to a bracket that groups the two bottom drivers (a mid-bass driver and a subwoofer) together. The speaker itself is a tall, black, rectangular cabinet with a wood-grain pattern on the right side. It has three drivers visible: a small tweeter at the top, a midrange driver in the middle, and two larger drivers (a mid-bass driver and a subwoofer) at the bottom. A small logo is visible at the bottom left of the speaker cabinet.

负极端连接柱

正极端连接柱

镀金铜棒

连接线插头

红色音箱连接线

功放机连接线

MD-VI

扬声器系统连接方法

连接方法二：（双线分音：用多台功放推）

- 1、确定功放机的电源处于关闭状态。
- 2、将MD-VI后接线板上的两组接线柱之间的连接铜棒拆下，让两组接线柱正极、负极处于断开状态。
- 3、将一台功放机的输出端左右声道正负极分别与MD-VI的上面一组接线柱连接，再将另一台功放的左右声道的正负极分别与MD-VI的下面一组接线柱连接。
- 4、最后打开功放机的电源。（这种连接方法需要再多购买本公司音箱连接线2条）。

另注：此方法仅供参考，实际音效与调试方法与器材搭配有关。

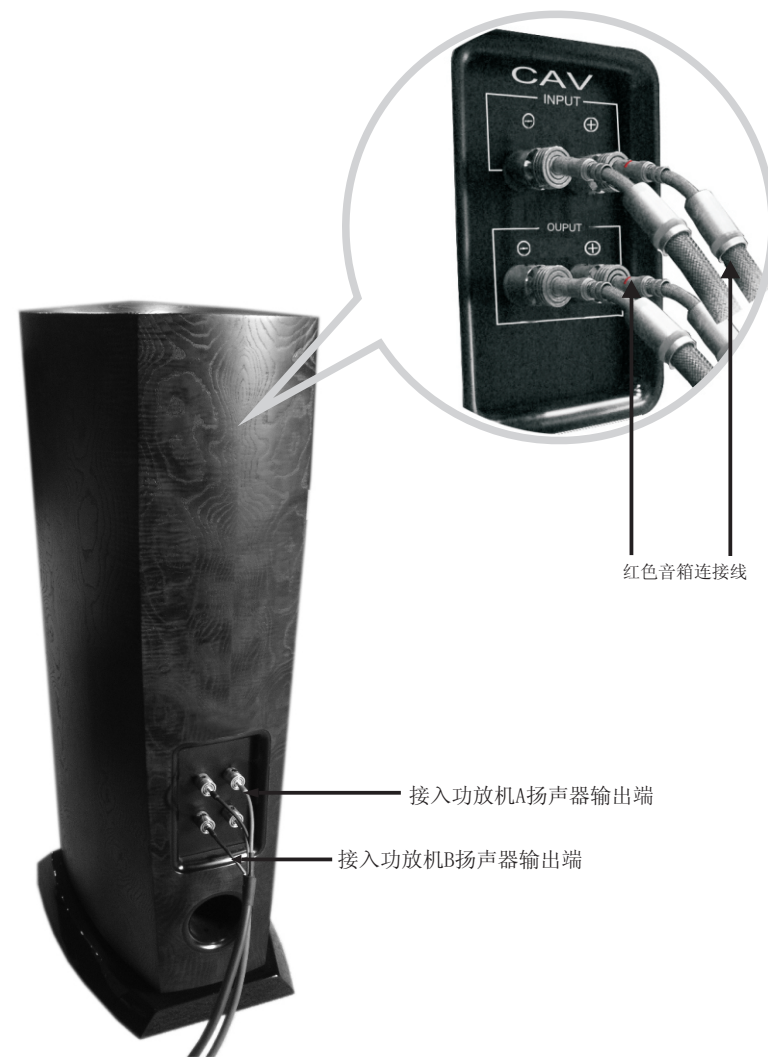

MD-VI

OPERATING GUIDE

Operating guide

The nominal power of the speaker refers to low frequency power. Excessive reliance on the mid and tweeter drivers or constant deviation from nominal distribution may result in damage due to overloading. Please note that damage caused by this is not covered by warranty. To ensure the HIGH FIDELITY performance, the sensitivity of this Hi-End speaker system is relatively low.

Notices

- 1.This speaker system was designed for domestic use only. If used outside of these guidelines, warranty may not apply and we would recommend that you seek for professional advice with regards to setup and installation.
- 2.By sound pressure testing, the recommended space requirement for optimum listening is 25 square meters-80 square meters in area and 2.8-7.0 meters vertical height.
- 3.European Community compliant in design and manufacture. No special power requirements apply.

Speaker placement

- 1.Place speakers to the front of listener and position symmetrically.
- 2.Do not place the speakers side by side. A minimum of 1.5 meter between speakers is recommended. Ideally, both speakers and listener should form a triangle to get the best stereo effect.
- 3.Place speakers close to the wall (leaving 20-50cm space) to better bass response. Ideally the tweeter drivers should be at listener's ear height.
- 4.Avoid direct sunlight and any liquid on the speakers.

MD-VI CONNECTION

Connection 2 (bi-wiring, driven by two amplifier)

- 1、Before connecting any wires, ensure the power amplifier is turned off.
- 2、Take off the two set of gold strap in the rear board, Ensure the Positive pole and Negative pole is disconnection.
- 3、Connect the positive and negative of the output for left(right) channel for the amplifier with the two wire post(+,-)on the upside of the rear board of MD-VI ;Connected the positive and negative of the output for left(right)channel the amplifier with the two wire post(+,-)on the underside of the rear board of MD-VI.
- 4、Now you can turn on the power of amplifier (For this way ,you should buy another cable from our company).

Note: This operating guide is only for reference. The actual performance should be relative to the quality of connecting cable and setting measurement.

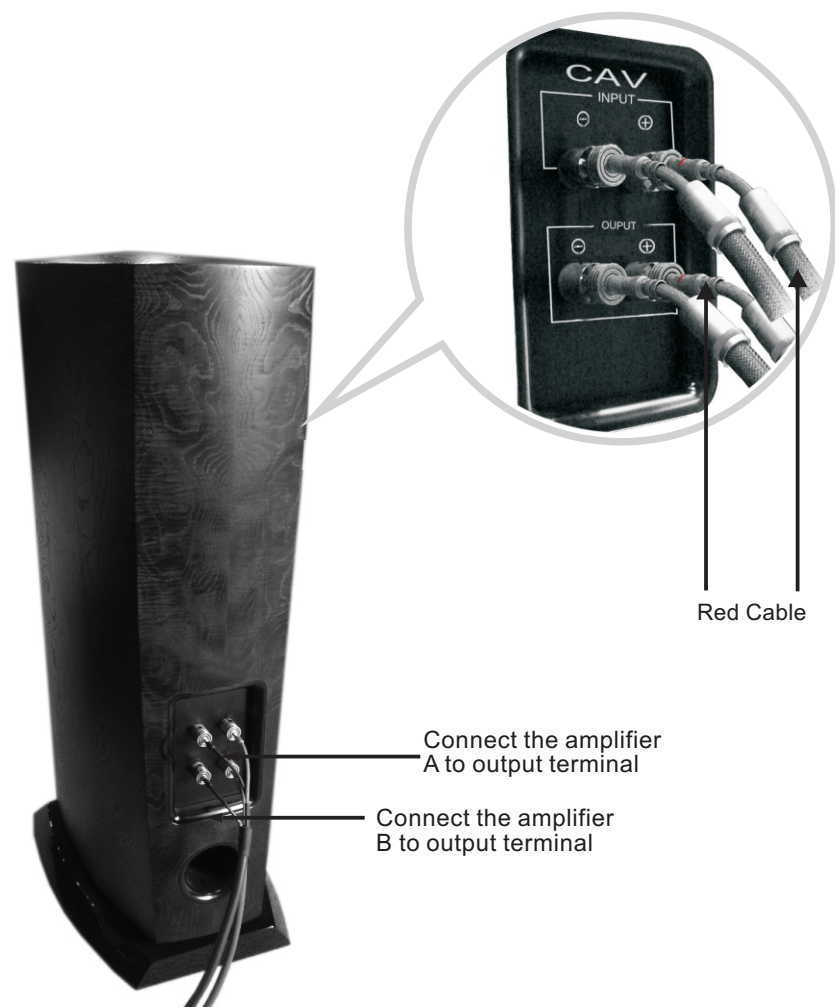

MD-VI 扬声器系统使用指南

使用指南:

一般的使用常识

本音箱的标称功率是指低频功率，过分地提升高音或中音使用，信号成份的比例严重偏离正常分布，将有可能使高、中音单元超负荷而损坏，在音响系统中，功率放大器的标称功率往往会大于音箱的标称功率，这是为了应付音乐信号中一些瞬间强信号缘故，也是音响系统的最基本要求之一。因此，在使用中需格外小心勿将音量开至最大，否则，将会造成损坏。（因此造成的损坏，我们将不负责免费保修）有的系统标称功率大，可能听起来声音并不大。这与音箱的灵敏度有关。灵敏度高，在相同的功率下，声音听起来就响得多，这当然是我们所希望的。但是，在高保真音响系统中，为了照顾高保真性（即：减少失真，以及整个频段的平衡）可能灵敏度会较低一些，这在您的使用中须引起注意。

提醒:

- 1、非专业扩声设备，如需特殊用途，请在专家指导下进行。
- 2、声压测试新界定的听音空间面积为 25m^2 — 80m^2 ，垂直高度：2.8m—7.0m。
- 3、欧共体标准适配性参数设计，对功放机无任何特殊要求，极易推动。

音箱的放置:

- 1、音箱应放置在听音位置的前方，左右对称地放置。
- 2、勿将音箱并排地放置地一起。轴线距离应大于1.5M，会使立体声的效果较佳。（一般来说，听音位置与两个音箱构成等三角形，效果是比较理想的。）
- 3、音箱靠墙约20—50厘米放置，会使低音听起来丰满。请注意音箱的放置高度，高音单元最好是接近人耳的高度。
- 4、避免阳光直接照射和雨淋。

MD-VI

扬声器系统技术规格

类型: 三路四单元倒相式音箱
 高音: 1寸高音单元×1只
 中音: 5.25寸中音单元×1只
 低音: 8寸低音单元×2只
 灵敏度: 88dB
 功率范围: 40W-300W
 阻抗: 4Ω
 频率范围: 35Hz-40KHz
 尺寸: H1258xW417xD556 (mm)
 净重: 89kg



MD-VI

CONNECTION

Connection 1 (Normal, driven by one amplifier)

- 1、 Before connecting any wires, ensure the power amplifier is turned off.
- 2、 Make sure that the golden flake between the top wire post(+,-) and the bottom wire post(+,-) are connected.
- 3、 Connect the speaker to the amplifier with the cable in the attachment. Ensure that the (+)pole (red) on the rear of the speakers are connected to the (+)pole(red) of the power amplifier.Ensure that the (-)pole (black) on the rear of the speakers are connected to the (-)pole (black)of the power amplifier.
- 4、 Now you can turn on the power of amplifier.

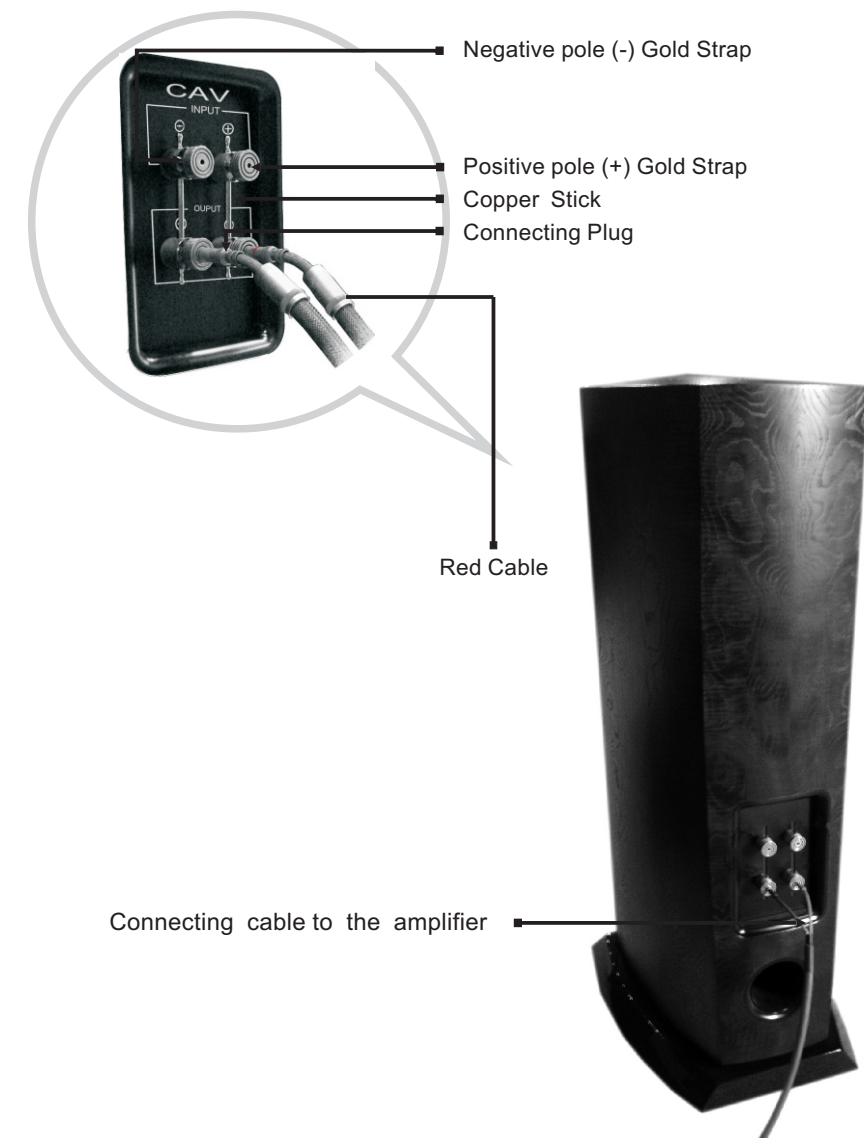

MD-VI

SPEAKER SYSTEM OPERATING INSTRUCTIONS

Key Features

- 1、Cabinet is made in multi-layer complex MDF in cold rolling technology and 3D palace supporting technology**
Cabinet is made in multi-layer complex MDF in cold rolling technology, which enhances MDF's hardness and touchness. Inside cabinet is made in 3D palace supporting technology, which is built with multi-layer wooden rack vertically and horizontally, the acoustic resonance is restrained effectively and vibration gets damping.
- 2、Fitted with Beryllium diaphragm tweeter produced by Scan-Speak**
This tweeter is “top of the range” with its pure beryllium diaphragm, large roll surround, and AirCirC Motor system, it provide a excellent-unsurpassed sound, outstanding off-axis response, low distortion and dynamic precision. Using Beryllium diaphragm technology enables the sound transfer speed up to 11000m/s which is much faster than used normal material, This ensures sound clear and clean, and with minimum distortion as well.
- 3、Fitted with Hexacone midrange and woofer produced by Eton**
Midrange and woofer is built in Hexacone by Eton, due to its flat construction method the chassis is additionally well suited for side mounting, it increases the hardness and vibration damping, which let middle frequency more clear and clean. Excellent vibration damping elements ensure better low frequency's instant response, fasterspeed but less distortion.
- 4、With best measurement by LEAP for loudspeaker systems**
In order to gain the best performance, the testing by leap is repeatedly and find out the best design for loudspeaker systems.

Precautions

- 1、Make sure the connecting wires are firmly connected to the power amplifier to prevent electrical leakage.
- 2、Place speakers close to the wall (leaving 20-50cm space) for better bass response.
- 3、Be sure that connecting wires have correct polarity to get the correct stereo effect.

Maintenance

- 1、Do not use speakers at peak loads constantly.
- 2、Always ensure that the volume in the low or minimum position before starting up.
- 3、To clean the surface, wipe with a dry soft cloth. Do not use chemical solvents such as mentholated spirits etc. which may cause damage to the surface of the speakers.

Accessories

Speaker cable in 3.6 meters (x2)

For the purpose of improvement, specification and design are subject to change without notice.

MD-VI

扬声器系统频率响应和阻抗特性曲线

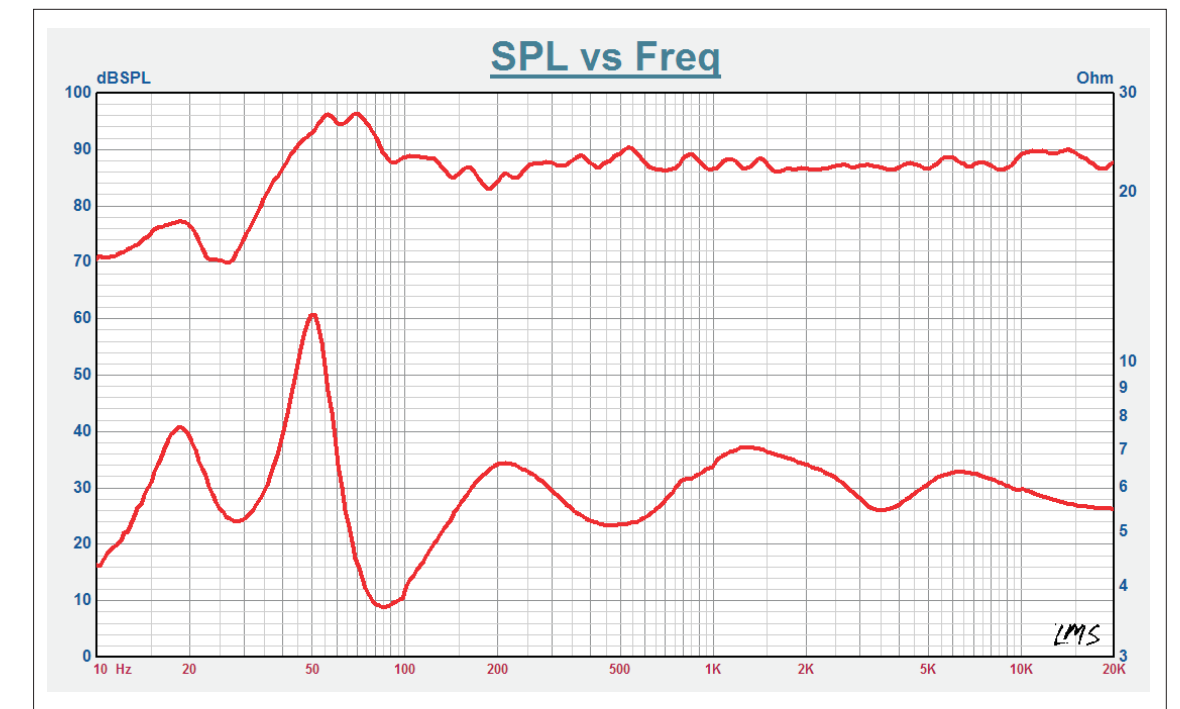

MD-VI频率响应/阻抗曲线图

MD-VI

SPEAKER SYSTEM OPERATING INSTRUCTIONS

Dear end-users,

Thank you and congratulation on your purchase CAV latest high-end speaker system-MD-VI. This system represents the perfect combination between beauty and real music, and CAV' updated design as well.

Our company's spirit is to give you noble life through our products. Please enjoy our products and enjoy your life.

To get the best performance and help maintain the system, please read this instruction manual carefully and keep it for future reference.